

**NORIKA EPC - EPOXY COATED
CAST IRON HUBLESS PIPE & FITTINGS**

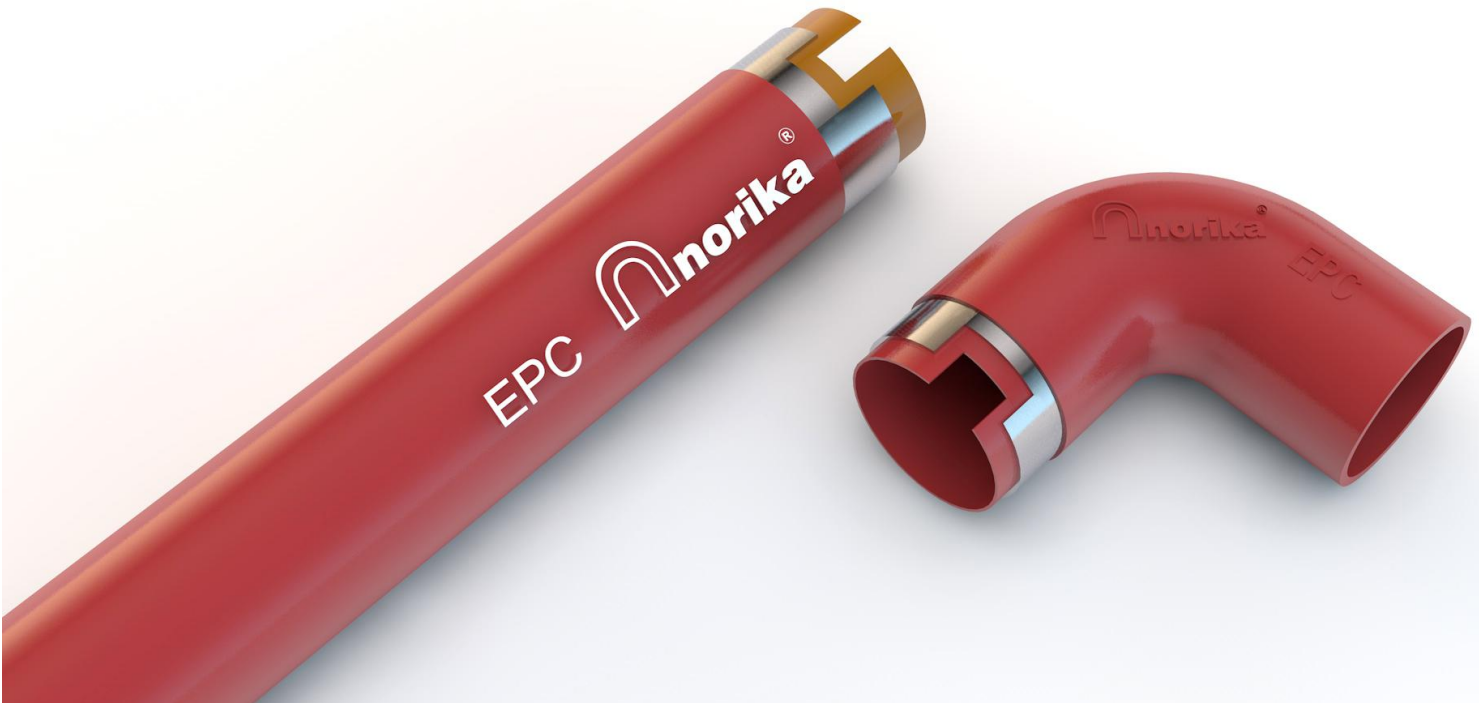



PRODUCT LISTING SCHEME

Certificate Number : STL-COC-Z0003
Issue No : 06

This Certificate is awarded to the following product(s) which has / have complied with the requirements of the listed standard(s).

Applicant : **Liang Chew Hardware Pte Ltd**
 133 Kitchener Road
 Singapore 208517

Product : Epoxy Coated Cast Iron Pipe & Fittings

Brand / Model : Norika / PIPHUBE & HUBE

Detail : Size (mm): 50, 75, 100, 150, 200, 250 & 300

Test Standard(s) : BS EN 877: 2021, BS EN 877: 1999 + A1 (2006), DIN EN 877: 2010, BS EN ISO 11925-2: 2010, BS EN 13823: 2010

Product conformity Certificates are awarded on the basis of an assessment of the following type-test report(s):

2423473/01-OYC, 2423473/03-OYC, 2322210-OYC, 2222084/01-OYC, 1920480-OYC, 1820252/01-OYC, 1820252/02-OYC, 7191039761-MEC12-01-CYW, 7191039761-MEC12-02-CYW, 7191039761-MEC12/5/1-JV, 7191039761-MEC12/5/2-JV, 7191039761-MEC12/5/3-JV, 7191039761-MEC12/04-LAS, 7191039761-MEC12/5/4-LGJ, 7191039761-MEC12-03-KCY

Date of Original Issue : 28 December 2018

Date of Last Revision : 20 March 2026

Date of Expiry : 27 December 2026

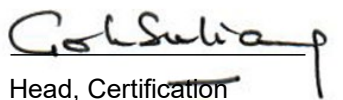
 Head, Certification
 Singapore Test Lab Pte Ltd

Page 1 of 1

This Certificate is part of a full report and should be read in conjunction with it. This Certificate remains the property of Singapore Test Lab Pte Ltd and shall be returned upon request. The use of this Certificate is subjected to the Terms and Conditions of Singapore Test Lab Pte Ltd. The manufacturer is solely responsible for the compliance of any product that has the same designation as the product type-tested.



Singapore Test Lab Pte Ltd certifies according to ISO / IEC 17065



EPC - EPOXY COATED CAST IRON HUBLESS PIPE



COMPLY WITH EN877:2010 01

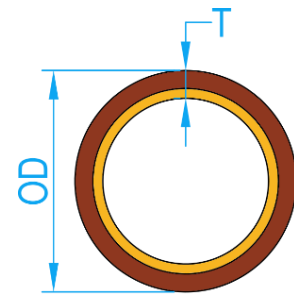
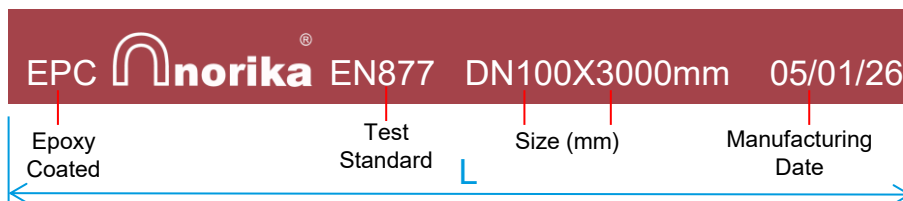
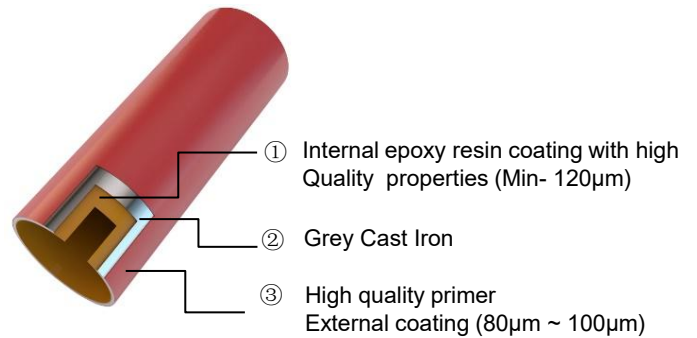

CROSS SECTIONAL VIEW

COATING CHARACTERISTIC

Pipes:

- The inner wall of the tube: two-component epoxy resins consists of a resin and a hardener component.

Color Number:#A46815

- The outer wall of the tube: The senior red iron alkyd enamel coating.

Color Number: #A63437

Note:

- Availability upon request.
- The tolerance for weight is $\pm 10\%$

COMPONENT PARTS

ITEM	LAYERS	THICKNESS
1	External Coating	80~100µm
2	Cast Iron	EN1561
3	Internal Coating	Min-120µm

DIMENSIONS

SKU	DN (mm)	OD MAX (mm)	OD MIN (mm)	T- NOMINAL (mm)	T- MIN (mm)	L [mm]	WEIGHT (kg)
PIPHUBE050	50	60.0	57.0	3.5	3.0	3000	13.0
PIPHUBE080	75	85.0	82.0	3.5	3.0	3000	18.9
PIPHUBE100	100	112.0	109.0	3.5	3.0	3000	25.2
PIPHUBE125	125*	137.0	133.0	4.0	3.5	3000	35.4
PIPHUBE150	150	162.0	158.0	4.0	3.5	3000	42.2
PIPHUBE200	200	212.0	208.0	5.0	4.0	3000	69.3
PIPHUBE250	250*	276.5	271.5	5.5	4.5	3000	99.8
PIPHUBE300	300*	328.5	323.5	6.0	5.0	3000	129.7

EPC - FUSION BONDED EPOXY COATED CAST IRON HUBLESS BEND & CROSS TEE



COMPLY WITH EN877:2010 01

COATING CHARACTERISTIC

Fittings:

Epoxy fittings inside and outside: Fusion bonded epoxy coating.

Coating Thickness: Min- 240µm

4"X2"X90 DEG BEND

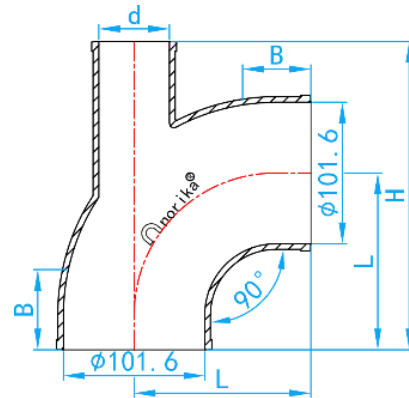
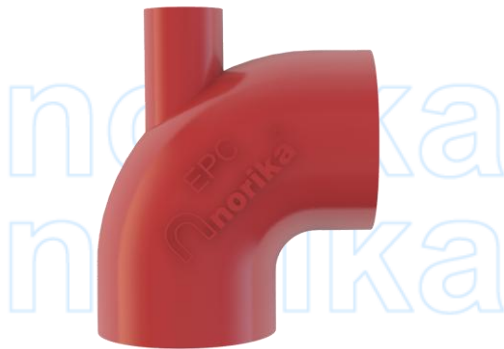

CROSS SECTIONAL VIEW

DIMENSIONS

SKU	SIZE (mm)	B (mm)	L (mm)	d (mm)	H (mm)	WEIGHT (kg)
HUBEB9010050	100X50	35	125	50.8	218	2.50

CROSS TEE 88°

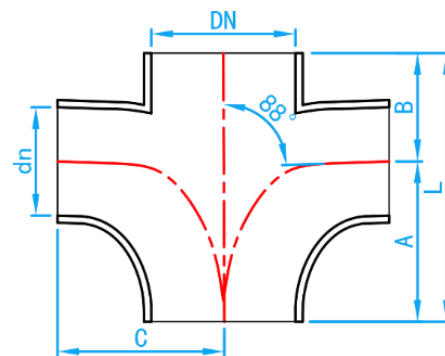

CROSS SECTIONAL VIEW

DIMENSIONS

SKU	DN (mm)	dn (mm)	A (mm)	B (mm)	L (mm)	C [mm]	WEIGHT (kg)
HUBECT10050	100	50	100	80	180	105	2.21
HUBECT100100	100	100	120	110	230	120	3.26
HUBECT150100	150	100	130	115	245	145	5.15

Notes: The tolerance for Weight is $\pm 10\%$.

EPC - FUSION BONDED EPOXY COATED CAST IRON HUBLESS SHORT PIPE WITH ACCESS DOOR



COMPLY WITH EN877:2010 01

COATING CHARACTERISTIC

Fittings:

Epoxy fittings inside and outside: Fusion bonded epoxy coating.

Coating Thickness: Min- 240µm

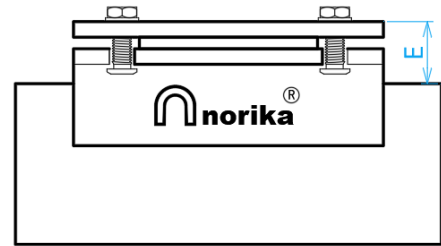

SIDE VIEW

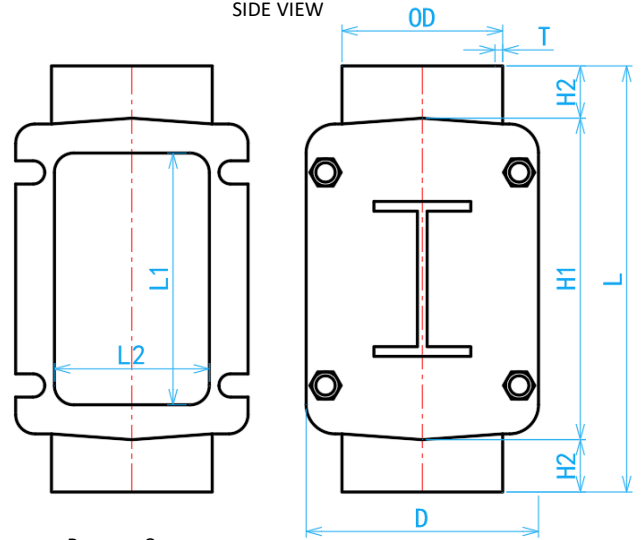

Remove Cover

FRONT VIEW

*Open the inspection cover seal and manually clear any blockage through the wide access door for easier maintenance.

DIMENSIONS

SKU	DN (mm)	OD (mm)	E (mm)	L (mm)	L1 (mm)	L2 (mm)	H1 (mm)	H2 (mm)	D (mm)	WEIGHT (kg)
HUBESP100	100	110	21	340	195	100	225	58	160	7.52
HUBESP150	150	160	21	395	245	150	275	60	216	12.80
HUBESP200	200	210	21	465	292	196	315	75	264	19.80
HUBESP250	250	274	28	575	338	258	380	97	330	38.00

Notes: The tolerance for Weight is $\pm 10\%$.

EPC - FUSION BONDED EPOXY COATED CAST IRON HUBLESS CAP & REDUCER



COMPLY WITH EN877:2010 01

COATING CHARACTERISTIC

Fittings:

Epoxy fittings inside and outside: Fusion bonded epoxy coating.

Coating Thickness: Min- 240µm

END CAP

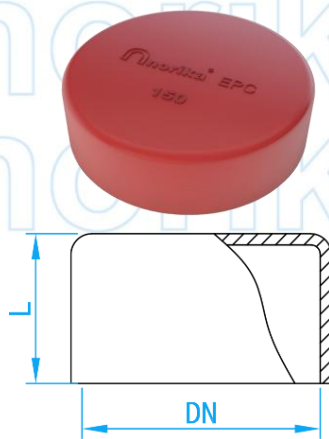

CROSS SECTIONAL VIEW

DIMENSIONS

SKU	DN (mm)	L (mm)	WEIGHT (kg)
HUBEEC050	50	30	0.23
HUBEEC080	75	35	0.50
HUBEEC100	100	40	0.71
HUBEEC150	150	50	1.80
HUBEEC200	200	60	2.80
HUBEEC250	250	70	6.00

DIMENSIONS

SKU	DN (mm)	L (mm)	A (mm)	WEIGHT (kg)
HUBERS08050	75X50	75	12.5	0.65
HUBERS10050	100X50	80	25	0.90
HUBERS10080	100X75	100	13.5	1.07
HUBERS125050	125X50	85	38.5	1.40
HUBERS125080	125X75	95	26	1.70
HUBERS125100	125X100	95	12.5	1.80
HUBERS150050	150X50	95	51	2.00
HUBERS150080	150X75	100	37.5	2.10
HUBERS150100	150X100	150	25	1.96
HUBERS150125	150X125	110	12.5	2.20
HUBERS200080	200X75	115	62.5	3.15
HUBERS200100	200X100	115	50	4.10
HUBERS200125	200X125	120	37.5	4.20
HUBERS200150	200X150	125	25	4.30
HUBERS250100	250X100	130	75	5.83
HUBERS250150	250X150	140	57	6.80
HUBERS250200	250X200	145	32	7.00
HUBERS300150	300X150	150	83	10.70
HUBERS300200	300X200	160	58	11.40
HUBERS300250	300X250	170	26	10.00

REDUCER

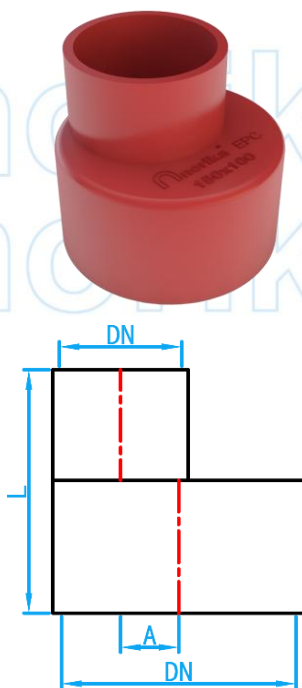

SIDE VIEW

***Availability upon request**
Notes: The tolerance for Weight is $\pm 10\%$.

EPC - FUSION BONDED EPOXY COATED CAST IRON HUBLESS BEND



COMPLY WITH EN877:2010 01

*Availability upon request

COATING CHARACTERISTIC

Fittings:

Epoxy fittings inside and outside: Fusion bonded epoxy coating.

Coating Thickness: Min- 240µm

15° BEND

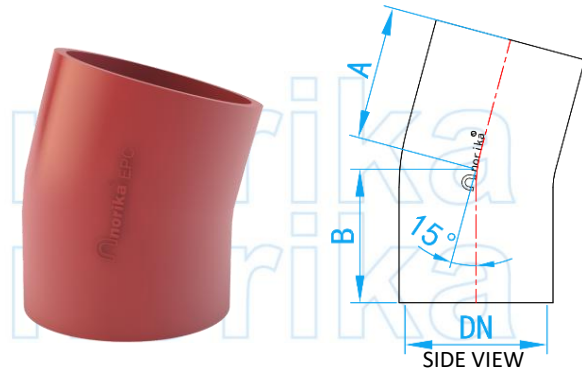

DIMENSIONS

SKU	DN (mm)	A (mm)	B (mm)	WEIGHT (kg)
HUBEB15050	50	40	40	0.6
HUBEB15080	75	50	50	0.8
HUBEB15100	100	50	50	1.0
HUBEB15125	125*	60	60	1.7
HUBEB15150	150	65	65	2.5
HUBEB15200	200	80	80	4.6

30° BEND

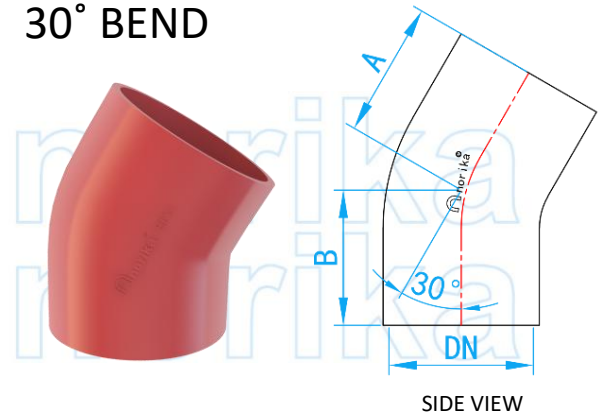

DIMENSIONS

SKU	DN (mm)	A (mm)	B (mm)	WEIGHT (kg)
HUBEB30050	50	45	45	0.5
HUBEB30080	75	60	60	0.8
HUBEB30100	100	60	60	1.3
HUBEB30125	125*	70	70	2.0
HUBEB30150	150	80	80	3.0
HUBEB30200	200	95	95	5.4
HUBEB30250	250	110	110	9.7
HUBEB30300	300	130	130	15.5

45° BEND

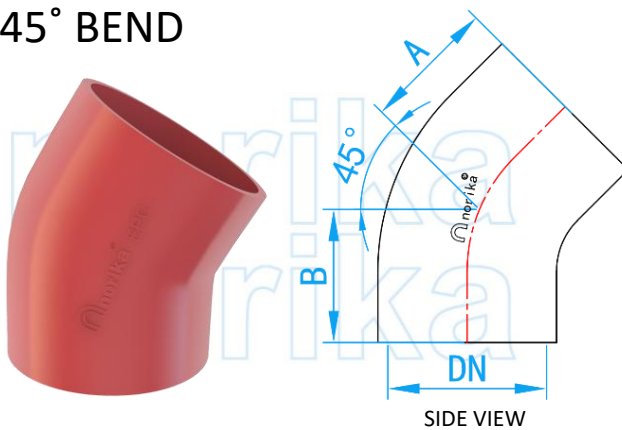

DIMENSIONS

SKU	DN (mm)	A (mm)	B (mm)	WEIGHT (kg)
HUBEB45050	50	60	60	0.5
HUBEB45080	75	60	60	1.0
HUBEB45100	100	70	70	1.6
HUBEB45125	125*	80	80	2.3
HUBEB45150	150	90	90	3.0
HUBEB45200	200	110	110	6.2
HUBEB45250	250	130	130	13.2
HUBEB45300	300	155	155	17.3

88° BEND

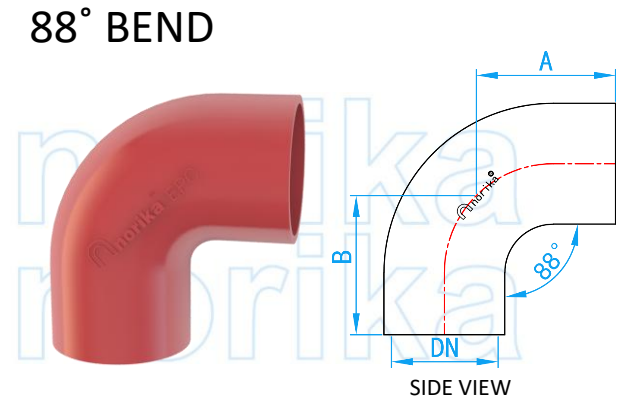

DIMENSIONS

SKU	DN (mm)	A (mm)	B (mm)	WEIGHT (kg)
HUBEB90050	50	75	75	0.7
HUBEB90080	75	95	95	1.4
HUBEB90100	100	110	110	2.1
HUBEB90125	125*	125	125	3.2
HUBEB90150	150	145	145	4.9
HUBEB90200	200	180	180	8.8
HUBEB90250	250	225	225	17.9
HUBEB90300	300	260	260	28.0

Notes: The tolerance for Weight is $\pm 10\%$.

EPC - FUSION BONDED EPOXY COATED CAST IRON HUBLESS BRANCH TEE 88°



COMPLY WITH EN877:2010 01

COATING CHARACTERISTIC
Fittings:

Epoxy fittings inside and outside: Fusion bonded epoxy coating.

Coating Thickness: Min- 240µm

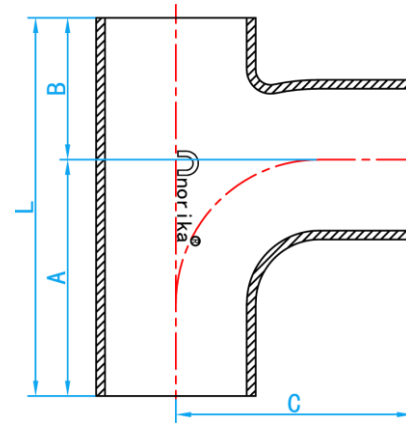

CROSS SECTIONAL VIEW

*Availability upon request

DIMENSIONS

SKU	DN (mm)	A (mm)	B (mm)	L (mm)	C (mm)	WEIGHT (kg)
HUBEET050	50X50	79	66	145	80	1.08
HUBERT08050	75X50	95	85	180	90	1.60
HUBEET080	75X75	95	85	180	90	1.61
HUBERT10050	100X50	94	76	170	105	2.00
HUBERT10080	100X75	105	90	195	110	2.65
HUBEET100	100X100	115	105	220	120	2.60
HUBERT12550	125X50*	98	82	180	120	3.00
HUBERT12580	125X75*	110	94	205	125	3.40
HUBERT125100	125X100*	125	110	235	130	4.00
HUBERT150050	150X50	100	100	200	140	3.78
HUBERT150080	150X75	110	110	220	145	5.00
HUBERT150100	150X100	130	115	245	145	4.95
HUBERT150125	150X125*	147	128	275	150	6.20
HUBEET150	150X150	158	142	300	155	5.86
HUBERT200100	200X100	144	126	270	175	7.40
HUBERT200150	200X150	173	152	325	185	9.00
HUBEET200	200X200	202	178	380	195	12.80
HUBERT250100	250X100	165	147	312	210	13.30
HUBERT250150	250X150	195	160	355	230	19.30
HUBERT250200	250X200	205	200	405	240	21.00
HUBEET250	250X250	250	220	470	240	24.50
HUBEET300	300X300	300	266	566	300	38.00

Notes: The tolerance for Weight is $\pm 10\%$.

EPC - FUSION BONDED EPOXY COATED CAST IRON HUBLESS BRANCH TEE 45°



COMPLY WITH EN877:2010 01

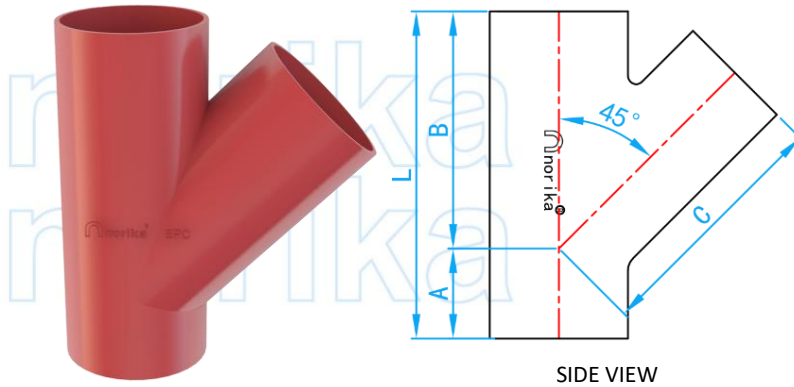

*Availability upon request

COATING CHARACTERISTIC

Fittings:

Epoxy fittings inside and outside: Fusion bonded epoxy coating.

Coating Thickness: Min- 240µm

DIMENSIONS

SKU	DN (mm)	A (mm)	B (mm)	L (mm)	C (mm)	WEIGHT (kg)
HUBEYT05050	50X50	50	135	185	135	1.4
HUBEYT08050	75X50	50	140	190	140	1.70
HUBEYT08080	75X75	65	160	225	160	2.4
HUBEYT100050	100X50	35	165	200	165	2.5
HUBEYT100080	100X75	55	175	230	175	3.3
HUBEYT100100	100X100	70	205	275	205	4.04
HUBEYT125050	125X50*	20	185	205	185	3.4
HUBEYT125080	125X75*	40	200	240	200	4.4
HUBEYT125100	125X100	60	220	280	220	5.2
HUBEYT150080	150X75	30	215	345	215	5.9
HUBEYT150100	150X100	55	240	295	240	6.44
HUBEYT150125	150X125*	70	255	325	255	8.0
HUBEYT150150	150X150	90	265	355	265	9.2
HUBEYT200080	200X75	15	240	255	240	8.5
HUBEYT200100	200X100	40	265	305	265	8.25
HUBEYT200125	200X125*	55	280	335	280	11.9
HUBEYT200150	200X150	75	300	375	300	11.86
HUBEYT200200	200X200	115	340	455	340	17.00
HUBEYT250100	250X100*	15	310	325	310	15.4
HUBEYT250125	250X125*	35	335	370	335	17.7
HUBEYT250150	250X150*	55	350	405	350	20.2
HUBEYT250200	250X200*	90	385	475	385	25.1
HUBEYT250250	250X250*	130	430	560	430	31.5
HUBEYT300100	300X100*	5	345	350	345	22.0
HUBEYT300125	300X125*	15	360	375	360	23.9
HUBEYT300150	300X150*	35	380	415	380	26.9
HUBEYT300200	300X200*	70	415	485	415	34.0
HUBEYT300250	300X250*	115	465	580	465	34.0
HUBEYT300300	300X300*	155	505	660	505	50.1

Notes: The tolerance for Weight is $\pm 10\%$.

EPC - FUSION BONDED EPOXY COATED CAST IRON HUBLESS TRAPS



COMPLY WITH EN877:2010 01

COATING CHARACTERISTIC
Fittings:

Epoxy fittings inside and outside: Fusion bonded epoxy coating.

Coating Thickness: Min- 240µm

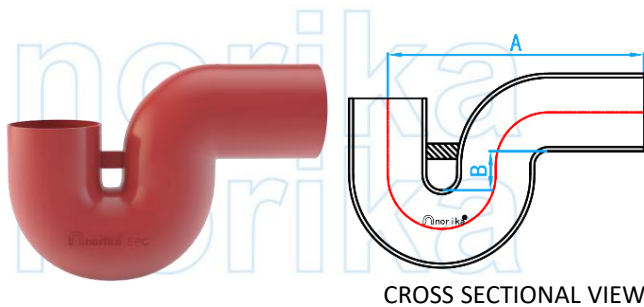

CROSS SECTIONAL VIEW

**P-TRAP
(100mmx100mm)**
DIMENSIONS

SKU	A (mm)	B (mm)	WEIGHT (kg)
HUBEPT100	358.5	53.5	7.12

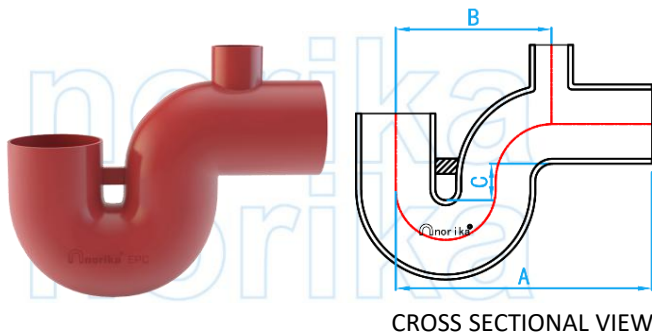

CROSS SECTIONAL VIEW

**P-TRAP
(100mmx100mmx50mm)**
DIMENSIONS

SKU	A (mm)	B (mm)	C (mm)	WEIGHT (kg)
HUBEPT10050	358.5	225	53.5	7.05

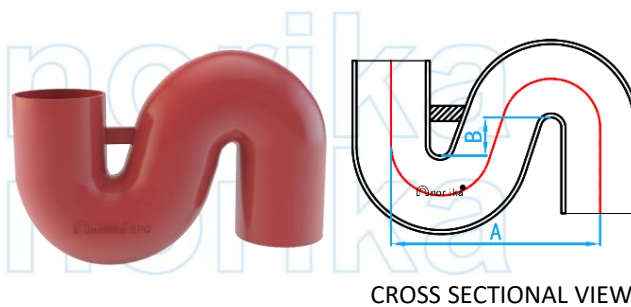

CROSS SECTIONAL VIEW

**S-TRAP
(100mmx100mm)**
DIMENSIONS

SKU	A (mm)	B (mm)	WEIGHT (kg)
HUBEST100	305	55.7	8.50

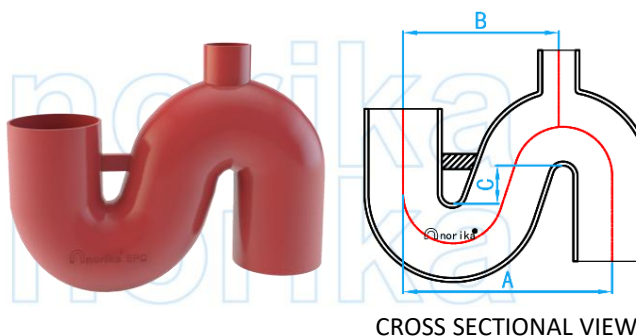

CROSS SECTIONAL VIEW

**S-TRAP
(100mmx100mmx50mm)**
DIMENSIONS

SKU	A (mm)	B (mm)	C (mm)	WEIGHT (kg)
HUBEST10050	305	228	55.7	7.75

Notes: The tolerance for Weight is $\pm 10\%$.

TYPE A CLIPS

COMPLY WITH CISPI 310-12
EN877:2010



INSTALLATION ASSEMBLY

COMPONENT PARTS		
ITEM	PARTS	MATERIAL
1	Housing	SS304
2	Worm Screw	SS304
3	Worm Drive Band	SS304
4	Shield	SS304
5	Gasket	EPDM

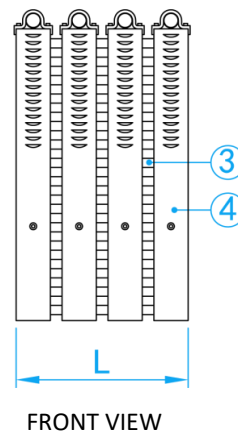

STANDARD SPECIFICATIONS

SKU	SIZE (mm)	Shield With L (mm)	Shield Thickness (mm)	Clamp Width (mm)	No. Clamps	H (mm)	D (mm)	Bolt Size (inch)	Pressure (BAR)	Install Torque (Nm)	Weight (kg)	PCS/CTN		
HUBC050	50	54	0.18	14.2	2	81.2	72	SS304 5/16 Slotted Hex Head worm Screw	0.5	7.5	0.13	100		
HUBC080	75	54			2	105.7	96.5						0.16	100
HUBC100	100	54			2	130	121						0.20	100
HUBC150	150	76			4	184	175						0.47	50
HUBC200	200	100			4	239	230						0.69	30
HUBC250	250	100			4	309	300						0.86	20
HUBC300	300	138			6	359	350						1.54	16

TYPE A REDUCE CLIPS

COMPLY WITH CISPI 310-2012



INSTALLATION ASSEMBLY

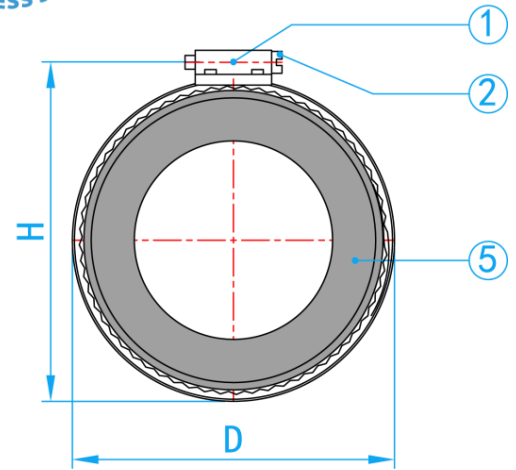

SIDE VIEW

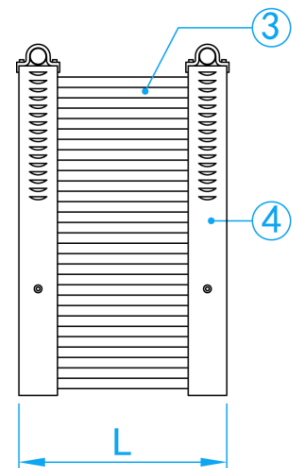

FRONT VIEW

COMPONENT PARTS

ITEM	PARTS	MATERIAL
1	Housing	Stainless Steel 304
2	Worm Screw	Stainless Steel 304
3	Worm Drive Band	Stainless Steel 304
4	Shield	Stainless Steel 304
5	Gasket	EPDM

STANDARD SPECIFICATIONS

SKU	SIZE (mm)	L (mm)	H (mm)	D (mm)	BOLT	BAR	Install Torque (Nm)	WEIGHT (kg)	PCS/CTN
HUBC05042	50 x 42	54	81.2	72	SS304 5/16 Slotted Hex Head Worm Screw	0.5	7.5	0.15	100
HUBC08050	75 x 50	54	105.7	96.5	SS304 5/16 Slotted Hex Head Worm Screw		7.5	0.26	100
HUBC10050	100 x 50	54	130	121	SS304 5/16 Slotted Hex Head Worm Screw		7.5	0.46	100
HUBC10080	100 x 75	54	130	121	SS304 5/16 Slotted Hex Head Worm Screw		7.5	0.51	100

TYPE B RAPID COUPLING

COMPLY WITH EN877:2010 01

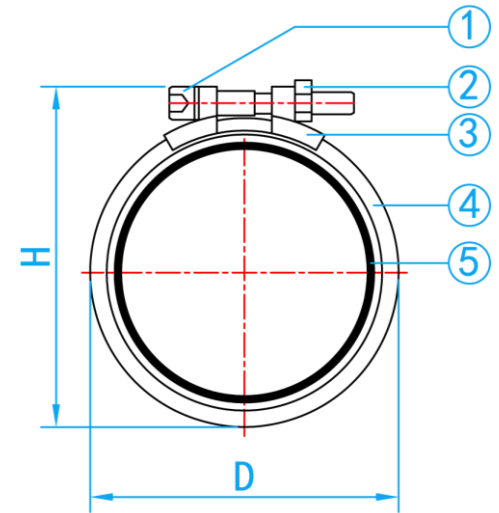

SIDE VIEW

INSTALLATION ASSEMBLY

COMPONENT PARTS

ITEM	PARTS	MATERIAL
1.	Hexagon Socket head Screw	Stainless Steel 304
2.	Wing Nut	Stainless Steel 304
3.	Locking Component	Stainless Steel 304
4.	Band Clamp	Stainless Steel 304
5.	Rubber Gasket	EPDM

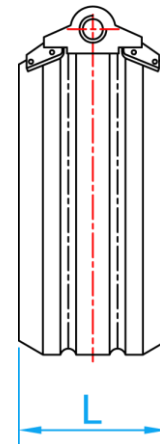

FRONT VIEW

STANDARD SPECIFICATIONS

SKU	SIZE (mm)	L (mm)	H (mm)	D (mm)	BOLT	BAR	INSTALL TORQUE (Nm)	WEIGHT (kg)
HUBC050B	50	41 ± 1	83.5	70.9	M8	0.5	11	0.1
HUBC080B	80	45 ± 1	108.0	98.9	M8		11	0.12
HUBC100B	100	45 ± 1	133.5	125.0	M8		15	0.21
HUBC125B	125	54 ± 1	158.2	150.0	M8		15	0.36
HUBC150B	150	54 ± 1	186.7	175.8	M8		15	0.38
HUBC200B	200	67 ± 1	244.0	227.0	M10		Until both locks come together	0.53

TYPE F HIGH RISE CLIPS

COMPLY WITH CISPI 301-2012



SKU: HUBC050F~HUBC080F



SKU: HUBC100F~HUBC150F



INSTALLATION ASSEMBLY

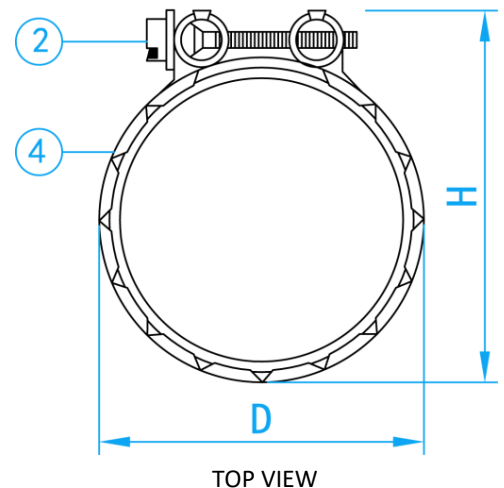
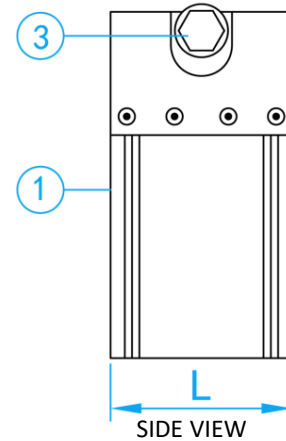

COMPONENT PARTS

ITEM	PARTS	MATERIAL
1.	Metal collar	Stainless steel 304
2.	Locking parts	Galvanized iron
3.	Slotted hex washer head bolt	Galvanized iron
4.	Gasket	EPDM

STANDARD SPECIFICATIONS

SKU	SIZE (mm)	H (mm)	D (mm)	L (mm)	BOLT	BAR	INSTALL TORQUE (Nm)	WEIGHT (kg)
HUBC050F	50	85.4	69.8	50 ± 1	GI M8 Slotted Hex Washer Head Bolt	0.5	7.5	0.20
HUBC080F	80	109.7	94.4	54 ± 1	GI M8 Slotted Hex Washer Head Bolt		7.5	0.25
HUBC100F	100	140.0	118.3	54 ± 1	GI M8 Slotted Hex Washer Head Bolt		7.5	0.30
HUBC150F	150	190.4	174.0	77 ± 1	GI M8 Slotted Hex Washer Head Bolt		7.5	0.56
HUBC200F	200	257.8 ± 2	220.0	104 ± 1	GI M8 Slotted Hex Washer Head Bolt		7.5	1.08

RAPID CLAMP KOMBI GRIP COLLAR

COMPLY WITH EN877:2010

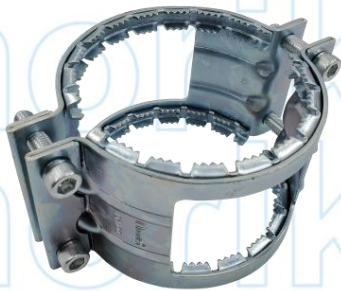

HUBKV050~150

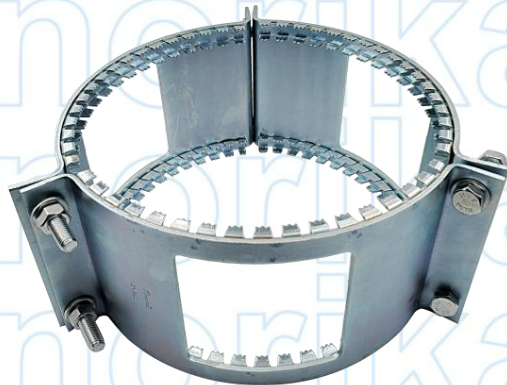

HUBKV200~300

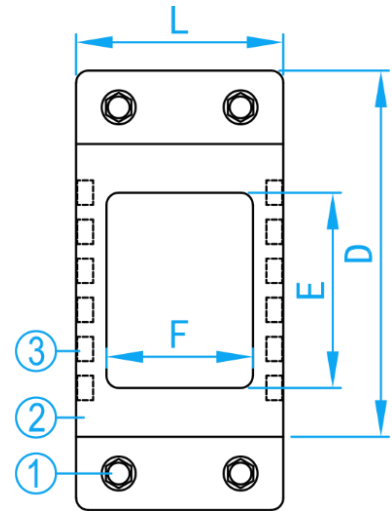

SIDE VIEW

COMPONENT PARTS

ITEM	PARTS	MATERIAL
1	Hexagon Socket Head Screw	Special Steel C/W Galvanized
2	Metal Collar	Special Steel C/W Galvanized
3	Claw Insert	Special Steel C/W Galvanized



INSTALLATION ASSEMBLY

DIMENSIONS

SKU	SIZE (mm)	L (mm)	D (mm)	E×F (mm)	BAR	BOLT	TORQUE (Nm)	WEIGHT (kg)
HUBKV050	50	88	106	60×60	7	M8	23~25	0.650
HUBKV080	80	88	130	64×60	5	M8	25~28	0.765
HUBKV100	100	88	160	84×60	5	M10	25~30	1.100
HUBKV125	125	118	210	84×60	5	M10	40~60	-
HUBKV150	150	118	230	104×82	5	M10	40~60	1.550
HUBKV200	200	146	287	130×110	2.5	M12	50~65	2.605
HUBKV250	250	146	320	140×110	2	M12	50~65	4.620
HUBKV300	300	185	419	150×145	1	M12	50~65	-

* Used axially, extension resistance with hubless stainless steel clips (Type A, Type B & Type F).

AISI304 RAPID CLAMP KOMBI GRIP COLLAR

COMPLY WITH EN877:2010



HUBKV050~150SS304

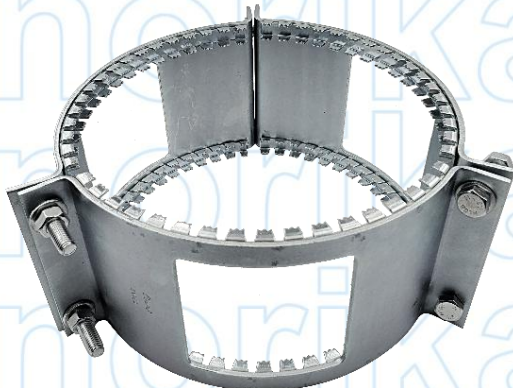

HUBKV200~300SS304

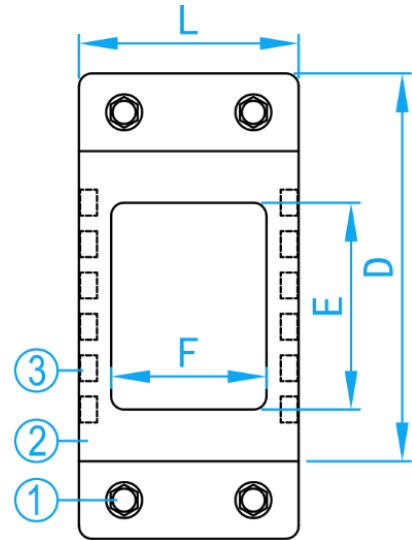

SIDE VIEW



INSTALLATION ASSEMBLY

COMPONENT PARTS

ITEM	PARTS	MATERIAL
1	Hexagon Socket Head Screw	AISI304
2	Metal Collar	AISI304
3	Claw Insert	AISI304

DIMENSIONS

SKU	SIZE (mm)	L (mm)	D (mm)	E×F (mm)	BAR	BOLT	TORQUE (Nm)	WEIGHT (kg)
HUBKV050SS304	50	88	106	60×60	7	M8	23~25	0.650
HUBKV080SS304	80	88	130	64×60	5	M8	25~28	0.765
HUBKV100SS304	100	88	160	84×60	5	M10	25~30	1.100
HUBKV125SS304	125	118	210	84×60	5	M10	40~60	-
HUBKV150SS304	150	118	230	84×80	5	M10	40~60	1.550
HUBKV200SS304	200	146	287	130×110	2.5	M12	50~65	2.605
HUBKV250SS304	250	146	320	140×110	2	M12	50~65	4.620
HUBKV300SS304	300	185	419	150×145	1	M12	50~65	-

* Used axially, extension resistance with hubless stainless steel clips (Type A, Type B & Type F).

Built For Water

Main Office

133 Kitchener Road
Singapore 208517

Mon-Fri: 8:00am - 5:30pm
Sat: 8:00am - 1:00pm
Sun & PH: Closed

North Office

10 Admiralty Street, North
Link Building #02-45
Singapore 757695

Mon-Fri: 8:00am - 5:00pm
Sat: 8:00am - 1:00pm
Sun & PH: Closed