

STAINLESS STEEL 316L PRESSFIT FITTINGS (M PROFILE)

COMPLY WITH BSEN1254-2: 1998

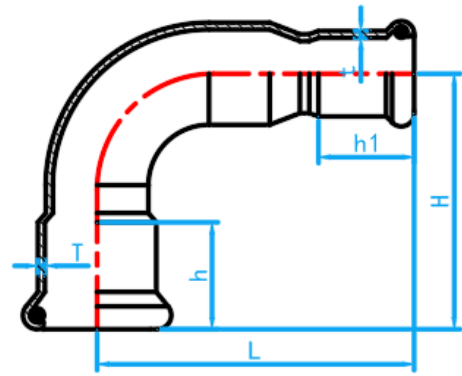

REDUCER 90° ELBOW



CROSS SECTIONAL VIEW

DIMENSIONS

| SKU | SIZE (mm) | H (mm) | L (mm) | h (mm) | h1 (mm) | T (mm) | t (mm) | WEIGHT (kg) | PCS/CTN |
|--------------------|-----------|--------|--------|--------|---------|--------|--------|-------------|---------|
| SS316LPFNRE9002015 | 22x15 | 52 | 43 | 21 | 20 | 1.5 | 1.5 | 0.065 | 160 |
| SS316LPFNRE9002515 | 28x15 | 60 | 43 | 23 | 20 | 1.5 | 1.5 | 0.075 | 140 |
| SS316LPFNRE9002520 | 28x22 | 62 | 50 | 23 | 21 | 1.5 | 1.5 | 0.095 | 160 |
| SS316LPFNRE9003515 | 35x15 | 63 | 43 | 26 | 20 | 1.5 | 1.5 | 0.100 | 100 |
| SS316LPFNRE9003520 | 35x22 | 70 | 50 | 26 | 21 | 1.5 | 1.5 | 0.115 | 80 |
| SS316LPFNRE9003525 | 35x28 | 76 | 60 | 26 | 23 | 1.5 | 1.5 | 0.135 | 70 |
| SS316LPFNRE9004215 | 42x15 | 72 | 43 | 31 | 20 | 1.5 | 1.5 | 0.125 | 60 |
| SS316LPFNRE9004220 | 42x22 | 73 | 50 | 31 | 21 | 1.5 | 1.5 | 0.145 | 60 |
| SS316LPFNRE9004225 | 42x28 | 84 | 60 | 31 | 23 | 1.5 | 1.5 | 0.165 | 60 |
| SS316LPFNRE9004235 | 42x35 | 87 | 72 | 31 | 26 | 1.5 | 1.5 | 0.200 | 60 |
| SS316LPFNRE9005015 | 54x15 | 82 | 43 | 36 | 20 | 1.5 | 1.5 | 0.170 | 56 |
| SS316LPFNRE9005020 | 54x22 | 87 | 50 | 36 | 21 | 1.5 | 1.5 | 0.186 | 56 |
| SS316LPFNRE9005025 | 54x28 | 93 | 60 | 36 | 23 | 1.5 | 1.5 | 0.215 | 56 |
| SS316LPFNRE9005035 | 54x35 | 97 | 72 | 36 | 26 | 1.5 | 1.5 | 0.245 | 30 |
| SS316LPFNRE9005042 | 54x42 | 105 | 85 | 36 | 31 | 1.5 | 1.5 | 0.298 | 30 |
| SS316LPFNRE9006525 | 67x28 | 115 | 60 | 50 | 23 | 1.8 | 1.5 | 0.354 | 15 |
| SS316LPFNRE9006535 | 67x35 | 118 | 72 | 50 | 26 | 1.8 | 1.5 | 0.394 | 15 |
| SS316LPFNRE9006542 | 67x42 | 84 | 85 | 50 | 31 | 1.8 | 1.5 | 0.428 | 15 |
| SS316LPFNRE9006550 | 67x54 | 108 | 105 | 50 | 36 | 1.8 | 1.5 | 0.523 | 15 |