

PEX PRESS-FIT FITTINGS

COMPLY WITH BS EN ISO 21003-1:2008
 BS EN ISO 21003-3:2008
 BS EN ISO 21003-5:2008
 BS EN 12165:2016
 AS/NZS 4020:2005
 SS 375:2015

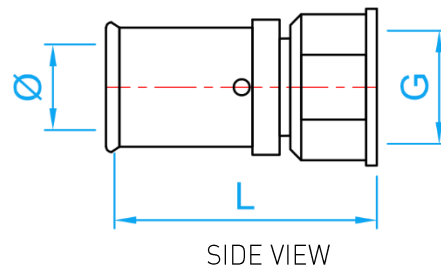

F5 FI ADAPTOR



DIMENSIONS

SKU	SIZE (mm x inch)	Ø (mm)	L (mm)	G BSP (inch)	WEIGHT (kg)	PCS/CTN
PEXF5FIA16	16 × 1/2"	11.8	42.5	1/2"	0.051	320
PEXF5FIA1620	16 × 3/4"	11.8	44.0	3/4"	0.069	240
PEXF5FIA2016	20 × 1/2"	15.8	42.5	1/2"	0.054	280
PEXF5FIA20	20 × 3/4"	15.8	44.0	3/4"	0.075	240
PEXF5FIA2025	20 × 1"	15.8	45.5	1"	-	-
PEXF5FIA2516	25 × 1/2"	19.8	49.0	1/2"	0.078	160
PEXF5FIA2520	25 × 3/4"	19.8	50.5	3/4"	0.086	160
PEXF5FIA25	25 × 1"	19.8	52.0	1"	0.135	96
PEXF5FIA3220	32 × 3/4"	25.8	50.5	3/4"	0.111	128
PEXF5FIA3225	32 × 1"	25.8	52.0	1"	0.141	96
PEXF5FIA32	32 × 1 1/4"	25.8	54.5	1 1/4"	0.177	84
PEXF5FIA4025	40 × 1"	31.8	66.0	1"	0.250	80
PEXF5FIA4032	40 × 1 1/4"	31.8	67.0	1 1/4"	0.290	72
PEXF5FIA40	40 × 1 1/2"	31.8	68.5	1 1/2"	0.330	60
PEXF5FIA5025	50 × 1"	40.8	66.0	1"	0.350	48
PEXF5FIA5032	50 × 1 1/4"	40.8	68.5	1 1/4"	-	-
PEXF5FIA5040	50 × 1 1/2"	40.8	69.0	1 1/2"	0.375	40
PEXF5FIA50	50 × 2"	40.8	75.0	2"	0.545	32
PEXF5FIA6325	63 × 1"	50.7	88.0	1"	0.595	20
PEXF5FIA6340	63 × 1 1/2"	50.7	92.0	1 1/2"	-	-
PEXF5FIA6350	63 × 2"	50.7	98.0	2"	0.720	20
PEXF5FIA63	63 × 2 1/2"	50.7	98.0	2 1/2"	0.929	16
PEXF5FIA7540	75 × 1 1/2"	59.6	94.0	1 1/2"	-	-
PEXF5FIA7563	75 × 2 1/2"	59.6	107.0	2 1/2"	1.089	12