

PEX PRESS-FIT FITTINGS

COMPLY WITH BS EN ISO 21003-1:2008
 BS EN ISO 21003-3:2008
 BS EN ISO 21003-5:2008
 BS EN 12165:2016
 AS/NZS 4020:2005
 SS 375:2015

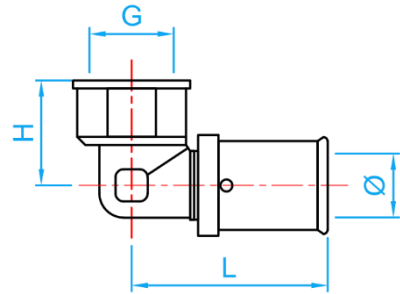

F5 FI ELBOW



SIDE VIEW

DIMENSIONS

SKU	SIZE (mm x inch)	Ø (mm)	G BSP (inch)	L (mm)	H (mm)	WEIGHT (kg)	PCS/CTN
PEXF5FIE16	16 × 1/2"	11.8	1/2"	41	23	0.067	240
PEXF5FIE1620	16 × 3/4"	11.8	3/4"	44.0	24.0	0.086	144
PEXF5FIE2016	20 × 1/2"	15.8	1/2"	41.0	25.0	0.077	176
PEXF5FIE20	20 × 3/4"	15.8	3/4"	44.0	26.0	0.099	120
PEXF5FIE2025	20 × 1"	15.8	1"	48.0	26.5	-	-
PEXF5FIE2516	25 × 1/2"	19.8	1/2"	48.0	26.0	0.109	96
PEXF5FIE2520	25 × 3/4"	19.8	3/4"	51.0	27.0	0.129	80
PEXF5FIE25	25 × 1"	19.8	1"	55.0	28.0	0.158	72
PEXF5FIE3220	32 × 3/4"	25.8	3/4"	51.0	29.5	0.164	72
PEXF5FIE3225	32 × 1"	25.8	1"	55.0	30.5	0.195	64
PEXF5FIE32	32 × 1 1/4"	25.8	1 1/4"	60.0	34.0	0.262	78
PEXF5FIE4025	40 × 1"	31.8	1"	65.5	33.0	0.260	40
PEXF5FIE4032	40 × 1 1/4"	31.8	1 1/4"	72.0	38.0	0.360	25
PEXF5FIE40	40 × 1 1/2"	31.8	1 1/2"	75.0	38.0	0.412	25
PEXF5FIE5025	50 × 1"	40.8	1"	66.5	37.0	0.368	25
PEXF5FIE5040	50 × 1 1/2"	40.8	1 1/2"	75.0	42.0	0.483	30
PEXF5FIE50	50 × 2"	40.8	2"	81.5	48.0	0.625	24
PEXF5FIE6325	63 × 1"	50.7	1"	90.0	42.0	-	-
PEXF5FIE6350	63 × 2"	50.7	2"	104.5	49.0	-	-