

STAINLESS STEEL PRESS FIT FITTINGS

COMPLY WITH BSEN1254-2:1998

MI 90° ELBOW

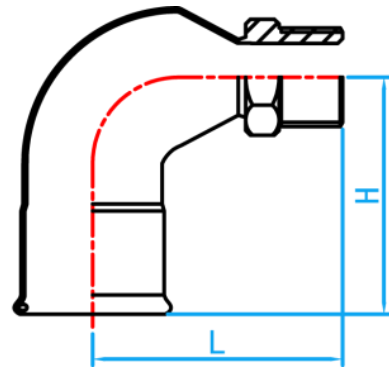

CROSS SECTIONAL VIEW

DIMENSIONS

SKU	SIZE (mm)	H (mm)	L (mm)	WEIGHT (kg)	PCS/CTN
SSPFNMIE015	15×1/2"BSPT	48	53	0.060	300
SSPFNMIE02015	22×1/2"BSPT	58	60	0.102	120
SSPFNMIE020	22×3/4"BSPT	58	61	0.131	90
SSPFNMIE02515	28×1/2"BSPT	62	71	0.130	100
SSPFNMIE025	28×1"BSPT	62	78	0.198	70
SSPFNMIE035	35×11/4"BSPT	80	77	0.242	55
SSPFNMIE042	42×11/2"BSPT	110	111	0.390	33
SSPFNMIE050	54×2"BSPT	122	129	0.640	21