

STAINLESS STEEL PRESS FIT FITTINGS

COMPLY WITH BSEN1254-2:1998

LONG SOCKET

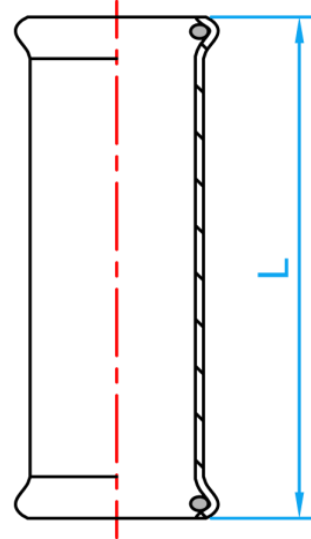

CROSS SECTIONAL VIEW

DIMENSIONS

SKU	SIZE (mm)	L (mm)	WEIGHT (kg)	PCS/CTN
SSPFNES015L	15	80	0.053	250
SSPFNES020L	22	85	0.086	100
SSPFNES025L	28	95	0.120	100
SSPFNES035L	35	105	0.150	60
SSPFNES042L	42	120	0.180	50
SSPFNES050L	54	135	0.290	40